



Used when high accuracy of machining is needed.

Standard accessories:

- 1 set of outside hard solid jaws
- 1 set of inside hard solid jaws
- 1 wrench
- 1 set of mounting screws.

Optional accessories:

- 1 set of hard master jaws
- 1 set of soft solid jaws
- 1 set of soft 2-piece jaws (hard master+top soft jaw)

三爪自定心卡盘用于高精度的加工过程。

标准配件:

- 一套正爪
- 一套反爪
- 一个扳手
- 一套螺丝

可选配件:

- 一套滑座
- 一套软上爪
- 一套分离爪 (滑座+软上爪)

K11 SERIES THREE-JAW SELF-CENTERING CHUCKS K11 三自定心卡盘

NTH

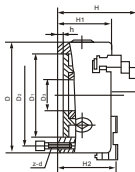
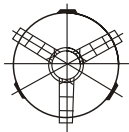

前锁 Front Mounting

规格表 SPECIFICATIONS

单位/UNIT:mm

卡盘尺寸 Chuck Size	D1	D2	D3	H	H1	h	z-d	最大输入扭矩NM Max.input torque	极限转速R.P.M Max.speed	净重Kg Net wt.	货号 Code No
80	55	66	16	66.5	50	4	3-M6	40	4000	1.9	K11-80
100	72	84	22	74.5	55	3	3-M8	60	3500	3.2	K11-100
125	95	108	30	84.5	58	4	3-M8	100	3000	5.0	K11-125
130	100	115	30	86.5	60	5	3-M8	100	3000	5.6	K11-130
160	130	142	45	94	65	5	3-M8	160	2500	8.8	K11-160
165	130	145	45	94	65	5	3-M8	160	2500	9.5	K11-165
190	155	172	55	105	75	5	3-M10	250	2000	13.8	K11-190
200	165	180	65	109	75	5	3-M10	250	2000	15.5	K11-200
230	190	210	70	120	80	6	3-M12	250	2000	16.5	K11-230
240	195	215	70	120	80	8	3-M12	320	1600	26	K11-240
250	206	226	80	120	80	5	3-M12	320	1600	27.5	K11-250
315	260	285	100	147.5	90	6	3-M16	400	1200	47.0	K11-315
320	270	290	100	147.5	90	6	3-M16	400	1200	47.5	K11-320
325	272	296	100	147.5	90	6	3-M16	400	1200	49.0	K11-325
380	325	350	135	155.7	98	6	3-M16	500	1000	68.0	K11-380
400	340	368	130	173.5	100	6	3-M16	500	1000	73.0	K11-400
500	440	465	210	202	115	6	6-M16	630	800	121	K11-500
630	560	595	270	218	133.5	7	6-M16	800	800	200	K11-630



Used when high accuracy of machining is needed.
For use on lathes, rotary tables, indexing heads, etc.

Standard accessories:

- 1 set of hard sectional jaws (master+hard top reversible)
- 1 wrench
- 1 set of mounting screws.

Optional accessories:

- 1 set of soft top jaws
- 1 set of outside hard solid jaws
- 1 set of inside hard solid jaws

三爪自定心卡盘用于高精度的加工过程。

标准配件:

- 一套分离爪
- 一个扳手
- 一套螺丝

可选配件:

- 一套软上爪
- 一套上爪
- 一套滑座

NTH

**K11 SERIES
THREE-JAW SELF-CENTERING CHUCKS(2-PIECE JAW)
K11 三自定心卡盘 (分离爪)**

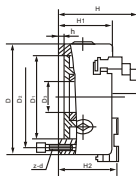
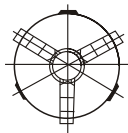

前锁 FRONT MOUNTING

SPECIFICATIONS

UNIT:mm

chuck size	D1	D2	D3	H	H1	H2	h	z-d	NM Max.input torque	R.P.M Max.speed	Kg Net wt.	Code No
125	95	108	30	95	58	63.0	4	3-M8	100	3000	4.8	K11-125A
130	100	115	30	97	60	65.0	5	3-M8	100	3000	4.3	K11-130A
160	130	142	45	109	65	71.0	5	3-M8	160	2500	8.3	K11-160A
190	155	172	55	122	75	78.0	5	3-M10	250	2000	9.5	K11-190A
200	165	180	65	122	75	78.0	5	3-M10	250	2000	13.0	K11-200A
230	190	210	70	136	80	84.0	6	3-M12	250	2000	14.5	K11-230A
240	195	215	70	136	80	84.0	8	3-M12	320	1600	22.5	K11-240A
250	206	226	80	136	80	86.0	5	3-M12	320	1600	23.0	K11-250A
315	260	285	100	156.5	90	99.5	6	3-M16	400	1200	41	K11-315A
320	270	290	100	156.5	90	99.5	6	3-M16	400	1200	42	K11-320A
325	272	296	100	156.5	90	99.5	6	3-M16	400	1200	41	K11-325A
380	325	350	135	173.5	98	107.5	6	3-M16	500	1000	46	K11-380A
400	340	368	130	173.5	100	112.5	6	3-M16	500	1000	62	K11-400A
500	440	465	210	202.0	115	126.0	6	6-M16	630	800	71	K11-500A
630	560	595	270	220.5	135	144.5	7	6-M16	800	800	200	K11-630A

A型：穿通螺钉连接
Form A Mounting from Front

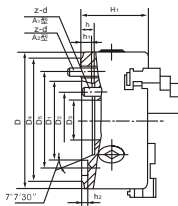

NTH

K11 SERIES DIRECT MOUNTING TYPEA1/A2
THREE-JAW SELF-CENTERING CHUCKS
K11 系列短锥三自定心卡盘,A1/A2型

A1型(穿通螺钉连接)
Form A1 (Use Inner Tapped Holes)

规格表 SPECIFICATIONS

单位/UNIT:mm

货号 Code No	D	D ₁	D ₂	D ₃	D ₄	D ₅	H ₁	h	h ₁	h ₂	d ₁	z-d	净重Kg Net wt.
K11200 /A1-5 K11200C/A1-5 K11200A/A1-5	200	82.563	61.9	40	133	104.8	84	14.288	12	6.5	16.3	3-M10	17
K11250 /A1-6 K11250C/A1-6 K11250A/A1-6	250	106.375	82.6	55	165	133.4	93	15.875	13	6.5	19.5	6-M12	31
K11325 /A1-6 K11325C/A1-6 K11325A/A1-6	325	106.375	82.6	55	165	133.4	106	15.875	13	6.5	19.5	6-M12	52
K11325 /A1-8 K11325C/A1-8 K11325A/A1-8	325	139.719	111.1	78	210	171.4	106	17.462	14	8	24.2	6-M16	53
K11380 /A1-8 K11380C/A1-8 K11380A/A1-8	380	139.719	111.1	78	210	171.4	118	17.462	14	8	24.2	6-M16	81
K11500A/A1-11	500	196.869	165.1	125	280	235	135	19.050	16	10	29.4	6-M20	159
K11500A/A1-15	500	285.775	247.6	200	380	330.2	135	20.638	17	10	35.7	6-M22	159

A2型(外圈螺钉连接)
Form A2 (Use Outer Tapped Holes)

规格表 SPECIFICATIONS

单位/UNIT:mm

货号 Code No	D	D ₁	D ₃	D ₄	D ₅	H ₁	h	h ₁	h ₂	d ₁	z-d	净重Kg Net wt.
K11200 /A2-4 K11200C/A2-4 K11200A/A2-4	200	63.513	60	108	86	82.6	-	10	6.5	14.7	3-M10	17
K11500A/A2-11	500	196.869	190	280	135	235	20	16	10	29.4	6-M20	159

C型：拔盘、螺栓锁紧连接
Form C Mounting With Studs and Locknuts

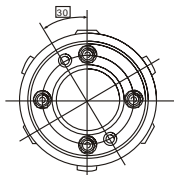
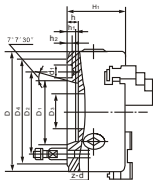

NTH

**K11 SERIES DIRECT MOUNTING TYPE C
 THREE-JAW SELF-CENTERING CHUCKS**

K11 系列短锥三自定心卡盘,C型

规格表 SPECIFICATIONS

单位/UNIT:mm

货号 Code No	D	D1	D2	D3	D4	H1	h	h1	h2	d1	z-d	净重Kg Net wt.
K11 125/C3	125	53.975	75	25	102	63	13	10	—	—	3-M10	6
K11 125/C4	125	63.513	85	25	112	63	13	10	6.5	14.7	3-M10	6
K11 160/C3 K11 160A/C3	160	53.975	75	40	102	76	13	10	—	—	3-M10	10
K11 160/C4 K11 160A/C4	160	63.513	85	40	112	70	13	10	6.5	14.7	3-M10	10
K11 160/C5 K11 160A/C5	160	82.563	104.8	40	135	73	15	12	6.5	16.3	4-M10	10
K11 200/C4 K11 200C/C4 K11 200A/C4	200	63.513	85	50	112	84	13	10	6.5	14.7	3-M10	17
K11 200/C5 K11 200C/C5 K11 200A/C5	200	82.563	104.8	50	135	84	15	12	6.5	16.3	4-M10	17
K11 200/C6 K11 200C/C6 K11 200A/C6	200	106.375	133.4	50	170	84	16	13	6.5	19.5	4-M12	17
K11 250/C5 K11 250C/C5 K11 250A/C5	250	82.563	104.8	70	135	95	15	12	6.5	16.3	4-M10	30
K11 250/C6 K11 250C/C6 K11 250A/C6	250	106.375	133.4	70	170	95	16	13	6.5	19.5	4-M12	30
K11 250/C8 K11 250C/C8 K11 250A/C8	250	139.719	171.4	80	220	95	18	14	8	24.2	4-M16	30
K11 315/C6 K11 315C/C6 K11 315A/C6	315	106.375	133.4	100	170	103.5	16	13	6.5	19.5	4-M12	53
K11 315/C8 K11 315C/C8 K11 315A/C8	315	139.719	171.4	100	220	106	18	14	8	24.2	4-M16	53
K11 315/C11 K11 315C/C11 K11 315A/C11	315	196.869	235	100	290	106	20	16	10	29.4	6-M20	53
K11 320/C6 K11 320C/C6 K11 320A/C6	320	106.375	133.4	100	170	103.5	16	13	6.5	19.5	4-M12	53
K11 320/C8 K11 320C/C8 K11 320A/C8	320	139.719	171.4	100	220	106	18	14	8	24.2	4-M16	53
K11 320/C11 K11 320C/C11 K11 320A/C11	320	196.869	235	100	290	106	20	16	10	29.4	6-M20	53
K11 325/C6 K11 325C/C6 K11 325A/C6	325	106.375	133.4	100	170	103.5	16	13	6.5	19.5	4-M12	53
K11 325/C8 K11 325C/C8 K11 325A/C8	325	139.719	171.4	100	220	106	18	14	8	24.2	4-M16	53
K11 325/C11 K11 325C/C11 K11 325A/C11	325	196.869	235	100	290	106	20	16	10	29.4	6-M20	53
K11 380/C8 K11 380C/C8 K11 380A/C8	380	139.719	171.4	130	220	118	18	14	8	24.2	4-M16	79
K11 380/C11 K11 380C/C11 K11 380A/C11	380	196.869	235	135	290	118	20	16	10	29.4	6-M20	79
K11 400/C8 K11 400C/C8 K11 400A/C8	400	139.719	171.4	130	220	118	18	14	8	24.2	4-M16	79
K11 400/C11 K11 400C/C11 K11 400A/C11	400	196.869	235	135	290	118	20	16	10	29.4	6-M20	79
K11 500/C11 K11 500C/C11 K11 500A/C11	500	196.869	235	190	290	135	20	16	10	29.4	6-M20	159
K11 500/C15 K11 500A/C15	500	285.775	330.2	210	400	135	21	17	10	35.7	6-M24	159
K11 630/C11 K11 630A/C11	630	196.869	235	252	290	135	20	16	10	29.4	6-M20	230
K11-630/C15 K11630A/C15	630	285.775	330.2	252	400	135	21	17	10	35.7	6-M24	230

D型：拉杆、凸轮锁紧连接

Form D Mounting With Studs and Camlocks

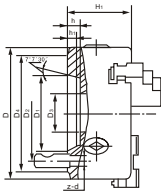

CAMLOCK



NTH

K11 SERIES DIRECT MOUNTING TYPE D
THREE-JAW SELF-CENTERING CHUCKS

K11 系列短锥三自定心卡盘, D型

规格表 SPECIFICATIONS

单位/UNIT:mm

货号 Code No	D	D1	D2	D3	D4	H1	h	H1	z-d	净重Kg Net wt.
K11 125/D3	125	53.975	70.6	25	92	63	13	10	3-M10X1	6
K11 125/D4	125	63.513	82.6	25	117	63	13	10	3-M10X1	6
K11 160/D3 K11 160A/D3	160	53.975	70.6	40	92	76	13	10	3-M10X1	10
K11 160/D4 K11 160A/D4	160	63.513	82.6	40	117	70	13	10	3-M10X1	10
K11 160/D5 K11 160A/D5	160	82.563	104.8	40	146	73	15	12	6-M12X1	10
K11 200/D4	200	63.513	82.6	50	117	86	13	10	3-M10X1	17
K11 200/D4 K11 200A/D4	200	63.513	82.6	50	117	86	13	10	3-M10X1	17
K11 200/D5	200	82.563	104.8	50	146	86	15	12	6-M12X1	17
K11 200/D5 K11 200A/D5	200	82.563	104.8	50	146	86	15	12	6-M12X1	17
K11 200/D6	200	106.375	133.4	50	181	86	16	13	6-M16X1.5	17
K11 200/D6 K11 200A/D6	200	106.375	133.4	50	181	86	16	13	6-M16X1.5	17
K11 250/D5	250	82.563	104.8	70	146	95	15	12	6-M12X1	31
K11 250/D5 K11 250A/D5	250	82.563	104.8	70	146	95	15	12	6-M12X1	31
K11 250/D6	250	106.375	133.4	70	181	98	16	13	6-M16X1.5	32
K11 250/D6 K11 250A/D6	250	106.375	133.4	70	181	98	16	13	6-M16X1.5	32
K11 250/D8	250	139.719	171.4	80	225	98	18	14	6-M12X1	32
K11 250/D8 K11 250A/D8	250	139.719	171.4	80	225	98	18	14	6-M12X1	32
K11 315/D6	315	106.375	133.4	100	181	103.5	16	13	6-M16X1.5	49
K11 315/D6 K11 315A/D6	315	106.375	133.4	100	181	103.5	16	13	6-M16X1.5	49
K11 315/D8	315	139.719	171.4	100	225	103.5	18	14	6-M20X1.5	49
K11 315/D8 K11 315A/D8	315	139.719	171.4	100	225	103.5	18	14	6-M20X1.5	49
K11 315/D11	315	196.869	235	100	298	103.5	20	16	6-M22X1.5	51
K11 315/D11 K11 315A/D11	315	196.869	235	100	298	103.5	20	16	6-M22X1.5	51
K11 320/D6	320	106.375	133.4	100	181	103.5	16	13	6-M16X1.5	50
K11 320/D6 K11 320A/D6	320	106.375	133.4	100	181	103.5	16	13	6-M16X1.5	50
K11 320/D8	320	139.719	171.4	100	225	103.5	18	14	6-M20X1.5	50
K11 320/D8 K11 320A/D8	320	139.719	171.4	100	225	103.5	18	14	6-M20X1.5	50
K11 320/D11	320	196.869	235	100	298	103.5	20	16	6-M22X1.5	52
K11 320/D11 K11 320A/D11	320	196.869	235	100	298	103.5	20	16	6-M22X1.5	52
K11 325/D6	325	106.375	133.4	100	181	103.5	16	13	6-M16X1.5	51
K11 325/D6 K11 325A/D6	325	106.375	133.4	100	181	103.5	16	13	6-M16X1.5	51
K11 325/D8	325	139.719	171.4	100	225	103.5	18	14	6-M20X1.5	51
K11 325/D8 K11 325A/D8	325	139.719	171.4	100	225	103.5	18	14	6-M20X1.5	51
K11 325/D11	325	196.869	235	100	298	103.5	20	16	6-M22X1.5	53
K11 325/D11 K11 325A/D11	325	196.869	235	100	298	103.5	20	16	6-M22X1.5	53
K11 380/D8	380	139.719	171.4	130	225	118	18	14	6-M20X1.5	81
K11 380/D8 K11 380A/D8	380	139.719	171.4	130	225	118	18	14	6-M20X1.5	81
K11 380/D11	380	196.869	235	135	298	118	20	16	6-M22X1.5	81
K11 380/D11 K11 380A/D11	380	196.869	235	135	298	118	20	16	6-M22X1.5	81
K11 400/D8	400	139.719	171.4	130	225	118	18	14	6-M20X1.5	81
K11 400/D8 K11 400A/D8	400	139.719	171.4	130	225	118	18	14	6-M20X1.5	81
K11 400/D11	400	196.869	235	135	298	118	20	16	6-M22X1.5	81
K11 400/D11 K11 400A/D11	400	196.869	235	135	298	118	20	16	6-M22X1.5	81
K11 500/D11	500	196.869	235	190	298	135	20	16	6-M22X1.5	159
K11 500/D11 K11500A/D11	500	196.869	235	190	298	135	20	16	6-M22X1.5	159
K11-500/D15	500	285.775	330.2	210	403	135	21	17	6-M24X1.5	159
K11-500/D15 K11500A/D15	500	285.775	330.2	210	403	135	21	17	6-M24X1.5	159
K11 630/D11	630	196.869	235	252	298	155	20	16	6-M22X1.5	250
K11 630/D11 K11630A/D11	630	196.869	235	252	298	155	20	16	6-M22X1.5	250
K11-630/D15	630	285.775	330.2	252	403	155	21	17	6-M24X1.5	250
K11-630/D15 K11630A/D15	630	285.775	330.2	252	403	155	21	17	6-M24X1.5	250

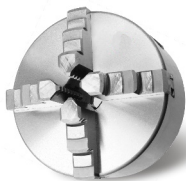

Used when high accuracy of machining is needed.

Standard accessories:

- 1 set of outside hard solid jaws
- 1 set of inside hard solid jaws
- 1 wrench
- 1 set of mounting screws.

Optional accessories:

- 1 set of hard master jaws
- 1 set of soft solid jaws
- 1 set of soft 2-piece jaws (hard master+top soft jaw)

三爪自定心卡盘用于高精度的加工。

标准配件:

- 一套正爪
- 一套反爪
- 一个扳手
- 一套螺丝

可选配件:

- 一套滑座
- 一套软上爪
- 一套分离爪 (滑座+软上爪)

NTH

K12 SERIES FOUR-JAW SELF-CENTERING CHUCKS

K12 系列四爪自定心卡盘

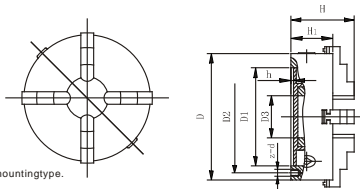

K12系列短锥的尺寸请参考K11短锥

Dimension for K12 direct mounting type, please see K11 direct mounting type.

SPECIFICATIONS

UNIT:mm

Chuck Size D	D ₁	D ₂	D ₃	H	H ₁	h	z-d	Kg Net wt.	Code No
80	55	66	16	66.5	50	4	3-M6	2.0	K12-80
100	72	84	22	74.5	53.5	3	3-M8	3.0	K12-100
125	95	108	30	84.5	58	4	3-M8	5.0	K12-125
130	100	115	30	86.5	60	5	3-M8	5.6	K12-130
160	130	142	45	94	65	5	3-M8	8.8	K12-160
165	130	145	45	94	65	5	3-M8	9.8	K12-165
190	155	172	55	105	75	5	3-M10	13.8	K12-190
200	165	180	65	109	75	5	3-M10	15.5	K12-200
240	195	215	70	120	80	8	3-M12	25	K12-240
250	206	226	80	120	80	5	3-M12	26	K12-250
315	260	285	100	147.5	90	6	3-M16	50	K12-315
320	270	290	100	147.5	90	6	3-M16	53	K12-320
325	272	296	100	147.5	90	6	3-M16	66	K12-325
380	325	350	130	173.5	100	6	3-M16	82	K12-380
400	340	368	130	173.5	100	6	3-M16	85	K12-400
500	440	465	210	202	115	6	6-M16	119	K12-500
630	560	595	260	220.5	135	6	6-M16	185	K12-630



Used when high accuracy of machining is needed.
For use on lathes, rotary tables, indexing heads, etc.

Standard accessories:

- 1 set of hard sectional jaws (master+hard top reversible)
- 1 wrench
- 1 set of mounting screws.

Optional accessories:

- 1 set of soft top jaws
- 1 set of outside hard solid jaws
- 1 set of inside hard solid jaws

四爪自定心卡盘用于高精度的加工过程。

标准配件:

- 一套分离爪
- 一个扳手
- 一套螺丝

可选配件:

- 一套软上爪
- 一套上爪
- 一套滑座

NTH

K12 SERIES FOUR-JAW SELF-CENTERING CHUCKS(2-PIECE JAW) K12 系列四爪自定心卡盘 (分离爪)

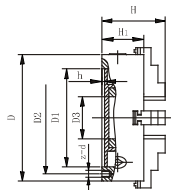
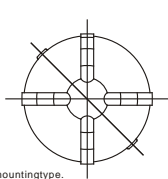

K12系列短锥的尺寸请参考K11短锥
Dimension for K12 direct mounting type, please see K11 direct mounting type.

SPECIFICATIONS

UNIT:mm

Chuck Size D	D ₁	D ₂	D ₃	H	H ₁	h	z-d	Kg Net wt.	Code No
125	95	108	30	95	58	4	3-M8	5	K12-125A
130	100	115	30	97	60	5	3-M8	5.6	K12-130A
160	130	142	45	109	65	5	3-M8	8.8	K12-160A
165	130	145	45	109	65	5	3-M8	9.8	K12-165A
190	155	172	55	122	75	5	3-M10	13.8	K12-190A
200	165	180	65	122	75	5	3-M10	15.5	K12-200A
240	195	215	70	136	80	8	3-M12	25	K12-240A
250	206	226	80	136	80	5	3-M12	26	K12-250A
315	260	285	100	156.5	90	6	3-M16	50	K12-315A
320	270	290	100	156.5	90	6	3-M16	53	K12-320A
325	272	296	100	156.5	90	6	3-M16	66	K12-325A
380	325	350	130	173.5	100	6	3-M16	66	K12-380A
400	340	368	130	173.5	100	6	3-M16	85	K12-400A
500	440	465	210	202	115	6	6-M16	119	K12-500A
630	560	595	260	220.5	135	6	6-M16	125	K12-630A

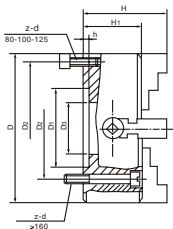

Standard accessories:

- 1 set of hard solid jaws
- 1 safety wrench
- 1 set of mounting screws.

标准配件:

- 1套卡爪
- 1个扳手
- 1套螺丝

NTH

K72 SERIES FOUR-JAW INDEPENDENT CHUCKS

K72 系列四爪单动卡盘

基本参数 General Parameters and Dimensions

单位/UNIT: mm

卡盘尺寸 Chuck Size	Size D inch	D ₁	D ₂	D ₃	H	H ₁	h	z-d	货号 Code No
80	3	55	66	22	58	42	3.5	4-M6	K72-80
100	4	72	84	25	77	54	4	4-M8	K72-100
125	5	95	108	30	78	56	4.5	4-M8	K72-125
160	6	65	95	45	96.5	65	5	4-M10	K72-160
160A	6	53	71	45	96.5	65	5	4-M10	K72-160A
160T	6	65	95	45	96.5	65	5	4-M10	K72-160T
200	8	125	104.8	50	110	75	6	4-M10	K72-200
200A	8	75	95	56	110	75	6	4-M10	K72-200A
200K	8	80	112	56	110	75	6	4-M10	K72-200K
250	10	100	120	65	117.5	82	6	4-M12	K72-250
250A	10	110	130	75	115.5	80	6	4-M12	K72-250A
300	12	152	130	75	128.5	85	6	4-M12	K72-300
320	13	140	165	95	134	90	6	4-M16	K72-320
350	14	130	168	80	145	95	8	4-M16	K72-350
400	16	160	185	125	143	95	8	4-M16	K72-400
450	18	180	205	140	147	100	8	4-M16	K72-450
500	20	200	236	160	161	106	8	4-M20	K72-500
630	25	220	258	180	180	115	10	4-M20	K72-630
800	32	250	300	210	210	135	12	8-M20	K72-800
1000	40	320	370	260	241	150	15	8-M20	K72-1000
1000A	40	285	330	280	241	150	75	8-M20	K72-1000A
1250	50	400	500	305	256	165	15	8-M20	K72-1250
1400	55	400	500	305	246	155	15	8-M20	K72-1400
1600	63	420	520	320	266	175	18	8-M24	K72-1600
2000	80	450	560	350	290	190	20	8-M30	K72-2000

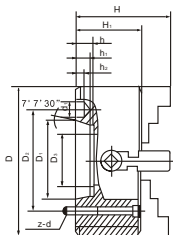

- Standard accessories:
- 1 set of hard solid jaws
 - 1 safety wrench
 - 1 set of mounting screws.

- 标准配件:
- 1套卡爪
 - 1个扳手
 - 1套螺丝

K72 SERIES DIRECT MOUNTING TYPE A1/A2 FOUR-JAW INDEPENDENT CHUCKS

K72 系列四爪单动短锥卡盘 A1/A2 型

NTH

A2型穿孔螺钉连接
Form A2: Mounting with perforating screw

SPECIFICATIONS

UNIT: mm

Chuck Size	Short-taper No.	D1	D2	D3	H	H1	h	h1	h2	d1	z-d	Code No
200	4	63.513	82.6	56	110	75	13	10	6.5	14.7	4-M10	K72-200/A2-4
250	4	63.513	82.6	56	115.5	80	13	10	6.5	14.7	4-M10	K72-250/A2-4
200	5	82.563	104.8	56	110	75	15	12	6.5	16.3	4-M10	K72-200/A2-5
250	5	82.563	104.8	75	115.5	80	15	12	6.5	16.3	4-M10	K72-250/A2-5
320	5	82.563	104.8	75	134	90	15	12	6.5	16.3	4-M10	K72-320/A2-5
250	6	106.375	133.4	75	115.5	80	16	13	6.5	19.5	4-M12	K72-250/A2-6
320	6	106.375	133.4	75	134	90	16	13	6.5	19.5	4-M12	K72-320/A2-6
350	6	106.375	133.4	95	141	90	16	13	6.5	19.5	4-M12	K72-350/A2-6
400	6	106.375	133.4	95	143	95	16	13	6.5	19.5	4-M12	K72-400/A2-6
250	8	139.719	171.4	75	115.5	80	18	14	8.0	24.2	4-M16	K72-250/A2-8
320	8	139.719	171.4	95	134	90	18	14	8.0	24.2	4-M16	K72-320/A2-8
400	8	139.719	171.4	125	143	95	18	14	8.0	24.2	4-M16	K72-400/A2-8
450	8	139.719	171.4	125	147	100	18	14	8.0	24.2	4-M16	K72-450/A2-8
500	8	139.719	171.4	130	161	106	18	14	8.0	24.2	4-M16	K72-500/A2-8
630	8	139.719	171.4	130	180	115	18	14	8.0	24.2	4-M16	K72-630/A2-8
800	8	139.719	171.4	130	210	135	18	14	8.0	24.2	4-M16	K72-800/A2-8
400	11	196.869	235.0	160	143	95	20	16	10.0	29.4	4-M20	K72-400/A2-11
500	11	196.869	235.0	160	161	106	20	16	10.0	29.4	4-M20	K72-500/A2-11
630	11	196.869	235.0	180	180	115	20	16	10.0	29.4	4-M20	K72-630/A2-11
800	11	196.869	235.0	180	210	135	20	16	10.0	29.4	4-M20	K72-800/A2-11
1000	11	196.869	235.0	180	241	150	20	16	10.0	29.4	4-M20	K72-1000/A2-11
1250	11	196.869	235.0	180	256	165	20	16	10.0	29.4	4-M20	K72-1250/A2-11
630	15	285.775	330.2	241	180	115	21	17	10.0	35.7	4-M22	K72-630/A2-15
800	15	285.775	330.2	180	210	135	21	17	10.0	35.7	4-M22	K72-800/A2-15
1000	15	285.775	330.2	280	241	150	21	17	10.0	35.7	4-M22	K72-1000/A2-15
1000T	15	285.775	330.2	280	241	150	21	17	20.0	35.7	8-M20	K72-1000T/A2-15
1250T	15	285.775	330.2	280	256	165	21	17	20.0	35.7	8-M20	K72-1250T/A2-15
1250	15	285.775	330.2	280	256	165	21	17	20.0	35.7	8-M22	K72-1250/A2-15
1400D	15	285.775	330.2	280	246	155	21	17	20.0	35.7	8-M20	K72-1400D/A2-15
1600D	15	285.775	330.2	280	266	175	21	17	20.0	35.7	8-M20	K72-1600D/A2-15
2000	15	285.775	330.2	280	290	190	21	17	20.0	35.7	8-M20	K72-2000/A2-15
1000	20	412.775	463.6	305	241	150	23	19	10.0	42.1	8-M24	K72-1000/A2-20
1250	20	412.775	463.6	305	256	165	23	19	10.0	42.1	8-M24	K72-1250/A2-20
1600	20	412.775	463.6	305	266	175	23	19	10.0	42.1	8-M24	K72-1600/A2-20
2000	20	412.775	463.6	305	290	190	23	19	10.0	42.1	8-M24	K72-2000/A2-20

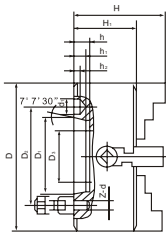

Standard accessories:

- 1 set of hard solid jaws
- 1 safety wrench
- 1 set of mounting screws.

标准配件:

- 1套卡爪
- 1个扳手
- 1套螺丝

NTH

K72 SERIES DIRECT MOUNTING
TYPE C FOUR-JAW INDEPENDENT CHUCKS

K72系列四爪单动短锥卡盘 C型

C型:拨盘、螺栓锁紧连接
Form C:Mounting with catch plate and locknuts

SPECIFICATIONS

UNIT: m

Chuck Size	Short-taper No.	D1	D2	D3	H	H1	h	h1	h2	d1	z-d	Code No
160	3	53.975	75.0	45	96.5	65	13	10	—	—	3-M10	K72-160/C3
160	4	63.513	85.0	56	96.5	65	13	10	6.5	14.7	3-M10	K72-160/C4
200	4	63.513	85.0	56	110	75	13	10	6.5	14.7	3-M10	K72-200/C4
250	4	63.513	85.0	56	115.5	80	13	10	6.5	14.7	3-M10	K72-250/C4
200	5	82.563	104.8	56	110	75	15	12	6.5	16.3	4-M10	K72-200/C5
250	5	82.563	104.8	56	115.5	80	15	12	6.5	16.3	4-M10	K72-250/C5
300	5	82.563	104.8	56	128.5	85	15	12	6.5	16.3	4-M10	K72-300/C5
320	5	82.563	104.8	56	134	90	15	12	6.5	16.3	4-M10	K72-320/C5
250	6	106.375	133.4	75	115.5	80	16	13	6.5	19.5	4-M12	K72-250/C6
300	6	106.375	133.4	75	128.5	85	16	13	6.5	19.5	4-M12	K72-300/C6
320	6	106.375	133.4	75	134	90	16	13	6.5	19.5	4-M12	K72-320/C6
350	6	106.375	133.4	75	141	90	16	13	6.5	19.5	4-M12	K72-350/C6
400	6	106.375	133.4	75	143	95	16	13	6.5	19.5	4-M12	K72-400/C6
500	6	106.375	133.4	75	161	106	16	13	6.5	19.5	4-M12	K72-500/C6
250	8	139.719	171.4	95	115.5	80	18	14	8.0	24.2	4-M16	K72-250/C8
320	8	139.719	171.4	95	134	90	18	14	8.0	24.2	4-M16	K72-320/C8
400	8	139.719	171.4	125	143	95	18	14	8.0	24.2	4-M16	K72-400/C8
500	8	139.719	171.4	125	161	106	18	14	8.0	24.2	4-M16	K72-500/C8
630	8	139.719	171.4	130	180	115	18	14	8.0	24.2	4-M16	K72-630/C8
400	11	196.869	235.0	160	143	95	20	16	10.0	29.4	6-M20	K72-400/C11
500	11	196.869	235.0	160	161	106	20	16	10.0	29.4	6-M20	K72-500/C11
630	11	196.869	235.0	180	180	115	20	16	10.0	29.4	6-M20	K72-630/C11
800	11	196.869	235.0	180	210	135	20	16	10.0	29.4	6-M20	K72-800/C11
1000	11	196.869	235.0	180	241	150	20	16	10.0	29.4	6-M20	K72-1000/C11
1250	11	196.869	235.0	180	256	165	20	16	10.0	29.4	6-M20	K72-1250/C11
630	15	285.775	330.2	180	180	115	21	17	10.0	35.7	6-M24	K72-630/C15
800	15	285.775	330.2	180	210	135	21	17	10.0	35.7	6-M24	K72-800/C15
1000	15	285.775	330.2	280	241	150	21	17	10.0	35.7	6-M24	K72-1000/C15
1250	15	285.775	330.2	280	256	165	21	17	10.0	35.7	6-M24	K72-1250/C15
1600	15	285.775	330.2	280	266	175	21	17	10.0	35.7	6-M24	K72-1600/C15

Standard accessories:

- 1 set of hard solid jaws
- 1 safety wrench
- 1 set of mounting screws.

标准配件:

- 1 套卡爪
- 1 个扳手
- 1 套螺丝

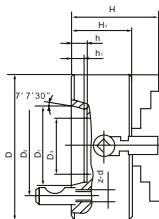

NTH

**K72 SERIES DIRECT MOUNTING
TYPE D FOUR-JAW INDEPENDENT CHUCKS**
K72 系列四爪单动短锥卡盘 D型

D型:拉杆、凸轮锁紧连接
Form D: Mounting with catch plate and locknuts

SPECIFICATIONS

UNIT: m

Chuck Size	Short-taper No.	D1	D2	D3	H	H1	h	h1	z-d	Code No
160	3	53.975	70.6	45	96.5	65	13	10	3-M10×1	K72-160/D3
160	4	63.513	82.6	56	96.5	65	13	10	3-M10×1	K72-160/D3
200	4	63.513	82.6	56	110	75	13	10	3-M10×1	K72-200/D4
250	4	63.513	82.6	56	115.5	80	13	10	3-M10×1	K72-250/D4
200	5	82.563	104.8	56	110	75	15	12	6-M12×1	K72-200/D5
250	5	82.563	104.8	56	115.5	80	15	12	6-M12×1	K72-250/D5
300	5	82.563	104.8	56	128.5	85	15	12	6-M12×1	K72-300/D5
320	5	82.563	104.8	56	134	90	15	12	6-M12×1	K72-320/D5
250	6	106.375	133.4	75	115.5	80	16	13	6-M16×1.5	K72-250/D6
300	6	106.375	133.4	75	128.5	85	16	13	6-M16×1.5	K72-300/D6
320	6	106.375	133.4	75	134	90	16	13	6-M16×1.5	K72-320/D6
350	6	106.375	133.4	75	141	90	16	13	6-M16×1.5	K72-350/D6
400	6	106.375	133.4	75	143	95	16	13	6-M16×1.5	K72-400/D6
320	8	139.719	171.4	95	134	90	18	14	6-M20×1.5	K72-320/D8
350	8	139.719	171.4	95	141	90	18	14	6-M20×1.5	K72-350/D8
400	8	139.719	171.4	125	143	95	18	14	6-M20×1.5	K72-400/D8
450	8	139.719	171.4	125	147	100	18	14	6-M20×1.5	K72-450/D8
500	8	139.719	171.4	125	161	106	18	14	6-M20×1.5	K72-500/D8
400	11	196.689	235.0	160	143	95	20	16	6-M22×1.5	K72-400/D11
500	11	196.689	235.0	160	161	106	20	16	6-M22×1.5	K72-500/D11
630	11	196.689	235.0	180	180	115	20	16	6-M22×1.5	K72-630/D11
800	11	196.689	235.0	180	210	135	20	16	6-M22×1.5	K72-800/D11
1000	11	196.689	235.0	180	241	150	20	16	6-M22×1.5	K72-1000/D11
630	15	285.775	330.2	180	180	115	21	17	6-M24×1.5	K72-630/D15
800	15	285.775	330.2	180	210	135	21	17	6-M24×1.5	K72-800/D15
1000	15	285.775	330.2	280	241	150	21	17	6-M24×1.5	K72-1000/D15
1250	15	285.775	330.2	280	256	165	21	17	6-M24×1.5	K72-1250/D15
1600	15	285.775	330.2	280	266	175	21	17	6-M24×1.5	K72-1600/D15



Lever scroll chuck is specially designed for grinding twist drills and other cutting tools.

Standard accessories:

- 1 operating lever
- 1 set of mounting screws
- 1 set of hard solid jaws

三爪自定心手紧卡盘

标准配件:

- 一个扳手
- 一套螺丝
- 一套卡爪

NTH

K01 SERIES THREE-JAW LEVER SCROLL CHUCKS K01 三爪自定心手紧卡盘

尺寸图 Dimensions



螺纹连接
Thread mtg.

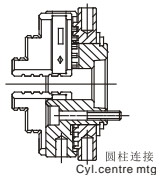
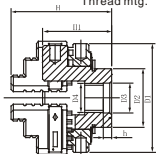

圆柱连接
Cyl. centre mtg.

夹持范围 Clamping Range

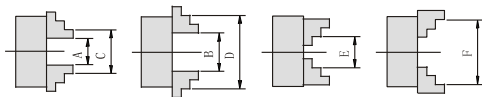

规格表 SPECIFICATIONS

单位/UNIT:mm

卡盘尺寸 Chuck Size	型号 Code No	D ₁	D ₂	D ₃	D ₄	h	H	H ₁
50	K01-50	50	28	15	M12×1 M14×1 SM3/4"×16	4	48	33
65	K01-65	68	28	15	M12×1 M14×1 SM3/4"×16	4	48	33
80	K01-80	84	45	25	3-M5	3	42	30

规格/型号 SPEC./MODEL	夹持范围 Max.Gripping Dia.			最高回转速 Max.Speed (r.p.m)	最大静夹持力 Max.Gripping Force (kN)	毛重 Gross Weight (Kg)
	正爪 Internal Jaws		反爪 External Jaws			
	A-B	C-D	E-F			
K01-50	1-15	20-48	20-47	9000	7	0.4
K01-65	2-16	25-60	22-55	8200	8	0.7
K01-80	2-18	25-75	22-63	7500	9	1.2

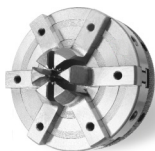

Lever scroll chuck is specially designed for grinding twist drills and other cutting tools.

Standard accessories:

- 1 operating lever
- 1 set of mounting screws
- 1 set of hard solid jaws

三爪自定心手紧卡盘

标准配件:

- 一个扳手
- 一套螺丝
- 一套卡爪

K03 SERIES SIX-JAW LEVER SCROLL CHUCKS K03 六爪自定心手紧卡盘

NTH

Dimensions

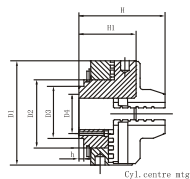
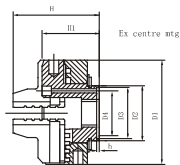
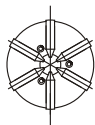

SPECIFICATIONS

UNIT:mm

Chuck Size	Code No	D1	D2	D3	D4	h	H	H1
80	K03-80-1	80	52	48	39	1.5	56	35
80	K03-80-2	80	52	38	30	3.0	56	35

SPECIFICATIONS

UNIT:mm

SPEC./MODEL	Max. Gripping Dia.	Max. Speed (r.p.m)	Max. Gripping Force (kN)	Gross Weight (Kg)
	Internal Jaws			
K03-80-1	2-20	7600	10	1.2
K03-80-2	2-20	7600	10	1.2



Used for machining all types of workpiece of irregular shapes.

Standard accessories:

- 1 set of outside hard solid jaws
- 1 set of inside hard solid jaws
- 1 wrench
- 1 set of mounting screws.

Optional accessories:

- 1 set of hard master jaws
- 1 set of soft solid jaws
- 1 set of soft 2-piece jaws (hard master+top soft jaw)

Size 500,630 with T-slots.

二爪自定心卡盘 适用于各种异形工件的加工。

标准配件:

- 一套正爪
- 一套反爪
- 一个扳手
- 一套螺丝

可选配件:

- 一套滑座
- 一套软上爪
- 一套分离爪 (滑座+软上爪)

K10 SERIES TWO-JAW SELF-CENTERING CHUCKS K10 二爪自定心卡盘

NTH



卡盘尺寸 Chuck Size	型号 Code No
80	K10-80
100	K10-100
125	K10-125
160	K10-160
200	K10-200
250	K10-250
315	K10-315
400	K10-400



卡盘尺寸 Chuck Size	型号 Code No
80	K10-80S
100	K10-100S
125	K10-125S
160	K10-160S
200	K10-200S
250	K10-250S
315	K10-315S
400	K10-400S

尺寸图 Dimensions

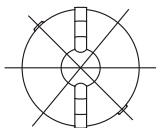

规格表 SPECIFICATIONS

单位/UNIT:mm

卡盘尺寸 Chuck Size	D ₁	D ₂	D ₃	H ₁	h	Z	D	H
80	55	66	16	50	4	3	M6	66.5
100	72	84	22	55	3	3	M8	74.5
125	95	108	30	58	4	3	M8	84.5
160	130	142	45	65	5	3	M8	94
200	165	180	65	75	6	3	M10	109
250	206	226	80	80	6	3	M12	120
315	260	285	100	90	6	3	M16	147.5
400	340	368	130	112.5	6	3	M16	173.5

规格表 SPECIFICATIONS

单位/UNIT:mm

规格/型号D SPEC./MODEL	夹持范围 Max. Gripping Dia		极限转速 Max. speed (r.p.m)	最大静夹持 Max. speed (r.p.m)	毛重 Gross Weight (Kg)
	正爪 Internal Jaws				
K10-80	2-70		4000	8	1.7
K10-100	2-90		3500	10	2.8
K10-125	2.5-125		3000	15	4.7
K10-160	3-160		2500	22	8
K10-200	4-200		2000	28	15
K10-250	6-250		1600	32	25
K10-315	10-315		1200	36	45
K10-400	15-400		1000	40	69

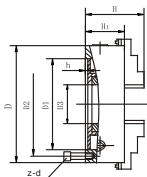



Wrench operated scroll chuck is specially designed for grinding twist drills and other cutting tools.

Plain back (front mounting). Metric and imperial execution of screws is available.

Standard accessories:

- 1 set of hard solid jaws
- 1 safety wrench
- 1 set of mounting screws.

六爪自定心卡盘

标准配件:

- 一套卡爪
- 一个扳手
- 一套螺丝

NTH

**K13 SERIES
SIX-JAW SELF-CENTERING CHUCKS
K13 系列六爪自定心卡盘**

Dimensions

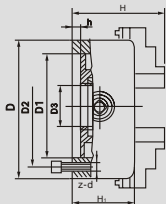
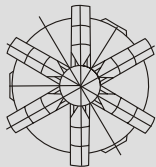

Chuck Size	Code No
100	K13-100Z
130	K13-130Z
165	K13-165Z
200	K13-200Z
252	K13-252Z

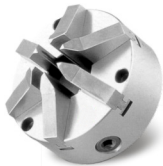

SPECIFICATIONS

UNIT:mm

Chuck Size	D	D ₁	D ₂	D ₃	H	H ₁	h	z-d	Kg Net wt.	Code No
100 (4")	72	84	26	74.5	55	3	3-M8	3.2	K13-100	
130 (5")	100	115	35	86.5	58	5	3-M8	5.6	K13-130	
165 (6")	130	145	45	94	65	5	3-M8	8.5	K13-165	
200 (8")	165	180	65	109	75	6	3-M10	16	K13-200	
252 (10")	206	226	80	120	80	6	3-M12	26	K13-252	

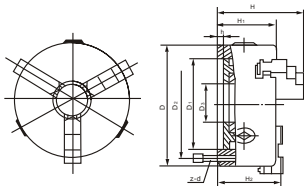
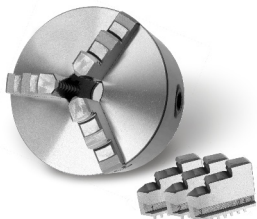

DK11型德标三爪自定心卡盘按照DIN6350标准生产，适用于德国标准的主轴，并配有前锁式规格。

DK11 DIN-type three jaw self-centering chuck is suitable for the main shaft of Germany's standard, produce according to DIN6350 standard. it have frontlock type as well.

NTH

DK11 SERIES DIN-TYPE THREE-JAW SELF-CENTERING CHUCKS

DK11 系列德标三爪自定心卡盘

规格表 SPECIFICATIONS

单位/UNIT:mm

Chuck Size	D1	D2	D3	H	H1	h	z-d	R.P.M Max speed	Code No	
									Solid Jaws	2-Piece Jaws
80	56	67	16	66.5	50	4	3-M6	4000	DK11-80	--
85	62	72	18	66.5	50	4	3-M6	4000	DK11-85	--
100	70	83	22	74.5	55	3	3-M8	3500	DK11-100	--
110	80	95	27	74.5	55	3	3-M8	3500	DK11-110	--
125	95	108	30	84.5	58	4	3-M8	3000	DK11-125	DK11-125A
140	105	120	40	84.5	58	4	3-M8	3000	DK11-140	DK11-140A
160	125	140	45	94	65	5	6-M10	2500	DK11-160	DK11-160A
200	160	176	65	109	75	5	6-M10	2000	DK11-200	DK11-200A
250	200	224	80	120	80	5	6-M12	1600	DK11-250	DK11-250A
315	260	286	100	156.5	90	6	6-M16	1200	DK11-315	DK11-315A
400	330	362	130	173.5	100	6	6-M16	1000	DK11-400	DK11-400A
500	420	458	210	205	115	6	6-M16	800	DK11-500	DK11-500A
630	545	586	252	220.5	135	7	6-M16	800	DK11-630	DK11-630A

DIN 6350

We also supply
DIN55026
DIN55027
DIN55029



Front-Mounting



2-Piece Jaws

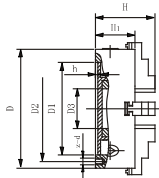
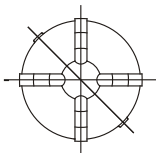
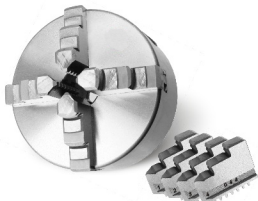

DK12型德标四爪自定心卡盘是按照DIN6350标准生产的适用于德国标准的主轴，并配有前锁式规格。

DK12 DIN-type four jaw self-centering chuck is suitable for the main shaft of Germany's standard, produce according to DIN6350 standard.it have frontlock type as well.

NTH

DK12 SERIES DIN-TYPE FOUR-JAW SELF-CENTERING CHUCKS

DK12 系列德标四爪自定心卡盘

规格表 SPECIFICATIONS

单位/UNIT:mm

Chuck Size	D1	D2	D3	H	H1	h	z-d	R.P.M Max speed	Code No	
									Solid Jaws	2-Piece Jaws
80	56	67	16	66.5	50	4	3-M6	4000	DK12-80	--
85	62	72	18	66.5	50	4	3-M6	4000	DK12-85	--
100	70	83	22	74.5	55	3	3-M8	3500	DK12-100	--
110	80	95	27	74.5	55	3	3-M8	3500	DK12-110	--
125	95	108	30	84.5	58	4	3-M8	3000	DK12-125	DK12-125A
140	105	120	40	84.5	58	4	3-M8	3000	DK12-140	DK12-140A
160	125	140	45	94	65	5	6-M10	2500	DK12-160	DK12-160A
200	160	176	65	109	75	5	6-M10	2000	DK12-200	DK12-200A
250	200	224	80	120	80	5	6-M12	1600	DK12-250	DK12-250A
315	260	286	100	156.5	90	6	6-M16	1200	DK12-315	DK12-315A
400	330	362	130	173.5	100	6	6-M16	1000	DK12-400	DK12-400A
500	420	458	210	205	115	6	6-M16	800	DK12-500	DK12-500A
630	545	586	252	220.5	135	7	6-M16	800	DK12-630	DK12-630A

DIN 6350

We also supply
DIN55026
DIN55027
DIN55029



Front-Mounting



2-Piece Jaws



TOP Accuracy & Quality Forged Steel, High Speed

Precision lathe chucks have top accuracy and the guarantee to maintain this accuracy for an extended period of time. These chucks have a modern and compact design. They can be used wherever high precision machining is demanded.

NTH

GK11 SERIES STEEL BODY THREE-JAW SELF-CENTERING CHUCKS

GK11 系列钢体三爪自定心卡盘

规格表 SPECIFICATIONS

单位/UNIT:mm

Chuck Size	D1	D2	D3	H	H1	h	z-d	R.P.M Max speed	Code No	
									Solid Jaws	2-Piece Jaws
80	56	67	16	66.5	50	4	3-M6	5500	GK11-80	--
85	62	72	18	66.5	50	4	3-M6	5500	GK11-85	--
100	70	83	22	74.5	55	3	3-M8	4700	GK11-100	--
110	80	95	27	74.5	55	3	3-M8	4700	GK11-110	--
125	95	108	30	84.5	58	4	3-M8	4300	GK11-125	GK11-125A
140	105	120	40	84.5	58	4	3-M8	4300	GK11-140	GK11-140A
160	125	140	45	94	65	5	6-M10	4000	GK11-160	GK11-160A
200	160	176	65	109	75	5	6-M10	3500	GK11-200	GK11-200A
250	200	224	80	120	80	5	6-M12	3000	GK11-250	GK11-250A
315	260	286	100	156.5	90	6	6-M16	2300	GK11-315	GK11-315A
400	330	362	130	173.5	100	6	6-M16	1800	GK11-400	GK11-400A
500	420	458	210	205	115	6	6-M16	1200	GK11-500	GK11-500A
630	545	586	252	220.5	135	7	6-M16	1200	GK11-630	GK11-630A

STEEL BODY

DIN6350
DIN55026
DIN55027
DIN55029



2-Piece Jaws

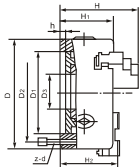
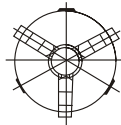

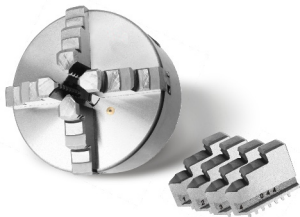

TOP Accuracy & Quality Forged Steel, High Speed

Precision lathe chucks have top accuracy and the guarantee to maintain this accuracy for an extended period of time. These chucks have a modern and compact design. They can be used wherever high precision machining is demanded.

NTH

GK12 SERIES STEEL BODY FOUR-JAW SELF CENTERING CHUCKS GK12 系列钢体四爪自定心卡盘

规格表 SPECIFICATIONS

单位/UNIT:mm

Chuck Size	D1	D2	D3	H	H1	h	z-d	R.P.M Max speed	Code No	
									Solid Jaws	2-Piece Jaws
80	56	67	16	66.5	50	4	3-M6	5500	GK12-80	--
85	62	72	18	66.5	50	4	3-M6	5500	GK12-85	--
100	70	83	22	74.5	55	3	3-M8	4700	GK12-100	--
110	80	95	27	74.5	55	3	3-M8	4700	GK12-110	--
125	95	108	30	84.5	58	4	3-M8	4300	GK12-125	GK12-125A
140	105	120	40	84.5	58	4	3-M8	4300	GK12-140	GK12-140A
160	125	140	45	94	65	5	6-M10	4000	GK12-160	GK12-160A
200	160	176	65	109	75	5	6-M10	3500	GK12-200	GK12-200A
250	200	224	80	120	80	5	6-M12	3000	GK12-250	GK12-250A
315	260	286	100	156.5	90	6	6-M16	2300	GK12-315	GK12-315A
400	330	362	130	173.5	100	6	6-M16	1800	GK12-400	GK12-400A
500	420	458	210	205	115	6	6-M16	1200	GK12-500	GK12-500A
630	545	586	252	220.5	135	7	6-M16	1200	GK12-630	GK12-630A

STEEL BODY

DIN6350
DIN55026
DIN55027
DIN55029



2-Piece Jaws

