

> DR SERIES

三爪後拉式夾頭

3-JAW DRAW DOWN POWER CHUCK



- ◎ 1.後拉式油壓夾頭作徑向夾持同時強力後拉，適用於鑄件及鍛件的加工。
- ◎ 2.後拉式夾持將工作緊貼在基準面上，使夾持穩固，適于重切削。
- ◎ 3.圓柱滑動結構，可長期適用，并確保重複夾持的優異精度。
- ◎ 4.準確的自定中心及強力夾持工作不上浮特性，要求長度精準的加工最便宜。
- ◎ Draw down power chuck feature of radial clamping will lead to almost no work piece uplifting displacement; for machining casting and forging part:
- ◎ For the clamped work-piece is appressed to the surface, chucks are suitable for heavy machining.
- ◎ Chuck Actuators with cylindrical structure are durable and ensures high clamping repeatability.
- ◎ Accurate self-centering and pull back features are adequate or precise length control machining requirements.

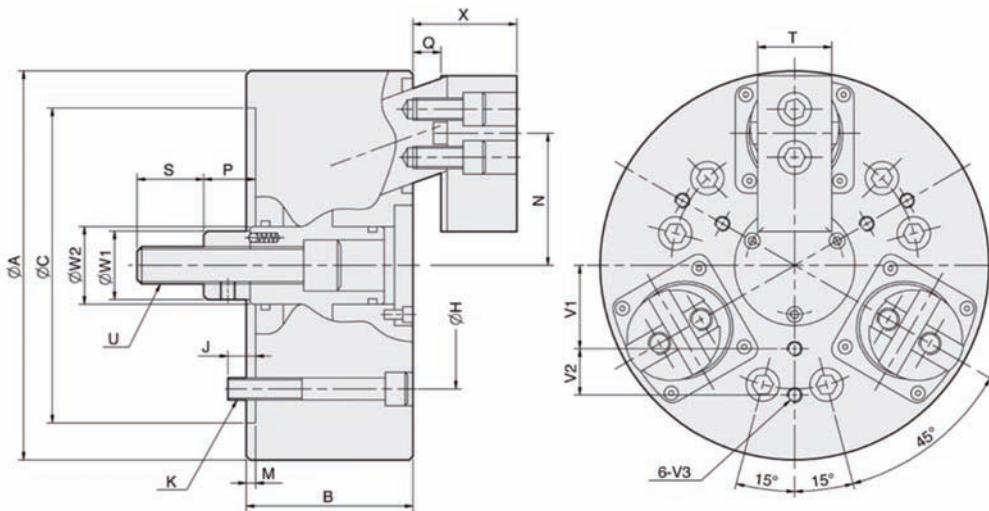

型式 Model	拉杆行程 (mm)	爪行程直徑 Jaw stroke dia (mm)	最大容許拉力 KN(kgf)	最大夾持力 Max clamping force (kgf)	最大使用油壓力 Max oil pressure (kgf/cm ²)	最高回轉速 Max R.P.M	重量 Weight (Kg)	慣性矩 kg·m ²	適合油壓缸 Matched cylinders	適合生爪 Matched HC	外徑夾持範圍 Clamping range (mm)
DR-06	10	7.2	15(1530)	25(2549)	2.1(21.4)	3500	15	0.05	MS105C	DR06-HC	Φ35-Φ165
DR-08	10	7.2	25(2590)	45(4589)	2.5(25.5)	3000	25	0.14	MS125C	DR08-HC	Φ40-Φ210
DR-10	16	11.6	35(3569)	60(6118)	3.3(34)	2500	49.2	0.4	MS125C	DR10-HC	Φ50-Φ254
DR-12	16	11.6	44(4480)	71(7240)	3.3(34)	2000	79.7	0.6	MS150C	DR12-HC	Φ50-Φ304

型式 Model	A	B	C	H	J	K	M	N Max	N Min	P Max	P Min	Q Max	Q Min	S	T	U	W1	W2	X Max	X Min	V1	V2	V3
DR-06	165	85	140	104.78	16	6*M10	5	58	54.4	33	23	14	4	36	35	M16*20	32	33.5	45	35	35	20	M6*12
DR-08	210	90	170	133.35	15	6*M12	5	71.3	67.7	38	28	15	5	36	40	M20*25	37	42	56	46	45	25	M8*16
DR-10	254	110	220	171.4	24	6*M16	5	87.8	82	48	32	22	6	46	50	M24*3	50	55	68	52	55	30	M8*16
DR-12	304	125	220	171.4	20	6*M16	5	102.8	97	47	31	21.5	5.5	50	60	M27*3	52	57	72.5	56.5	65	35	M8*16

* 保留技術更改的權利，恕不另行通知 Subject to technology changes without prior information
 * 非標需求可訂做 Non-standard requirements can be made

