

強力超薄型夾盤

NBK POWERFUL TYPE SUPER THIN CHUCKS

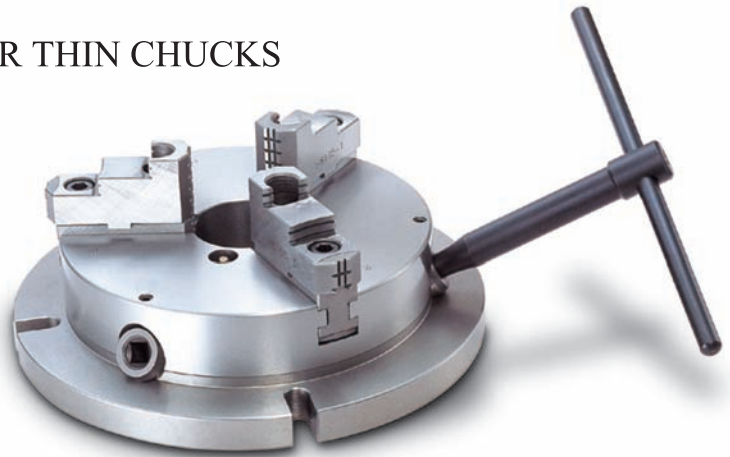

強力超薄型夾盤之特色：

- ◎ 1.把手和盤面成30°角，旋轉操作更便利。
- ◎ 2.薄型設計，可增加機械加工之容許長度。
- ◎ 3.外徑成凸緣設計，裝卸容易。
- ◎ 4.強力型設計可共用生爪。

SUPER THIN CHUCKS

- ◎ 1.The handle with an angle of 30 degrees is much convenient for operations.
- ◎ 2.The "super thin thickness" design of chucks increase the "allowable distance" of machining operations.
- ◎ 3.Chuck flange makes loading and unloading operations simpler and more convenient.
- ◎ 4.Hard jaws and Soft jaws can be used alternatively.

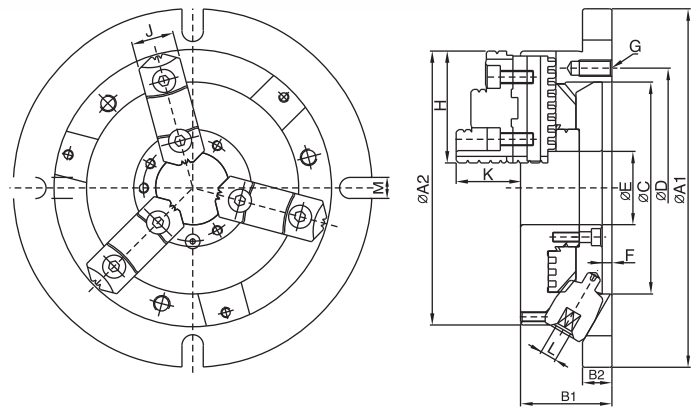

尺寸圖 / DIMENSIONS

規格 / Specification

單位/UNIT:mm

型式 / 規格 MODEL/SPEC.	A1	A2	B1	B2	C	D	E	F	G	H
NBK-06	220	170	58	18	130	147	45	6	3-M10x1.5P	68
NBK-08	270	210	65	20	155	172	60	6	3-M10x1.5P	82
NBK-10	315	255	73	20	190	210	80	6	3-M12x1.75P	93
NBK-12	370	305	80	22	250	285	105	5	3-M12x1.75P	118

型式 / 規格 MODEL/SPEC.	J	K	L	M	把握範圍 Max.Gripping Diameter		淨重 Weight (kg)
					外徑把握 O.D.Clamping (mm)	內徑把握 I.D.Clamping (mm)	
NBK-06	26	40	10	13	ø8~ø160	ø48~ø150	10.6
NBK-08	28	43	11	13	ø11~ø200	ø62~ø190	18.1
NBK-10	32	52	12	16	ø12~ø250	ø72~ø240	27.9
NBK-12	40	59	14	18	ø15~ø300	ø86~ø290	42.9