

日系卡盤T型塊

T-NUT FOR JIS CHUCK SERIES

J1形 J1 TYPE

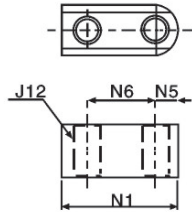

J2形 J2 TYPE

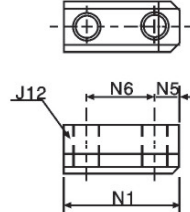

J3形 J3 TYPE

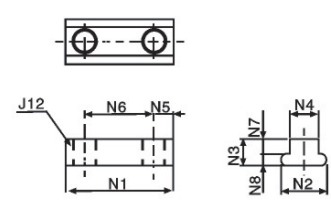

Chuck series number	N1	N2	N3	N4	N5	N6	N7	N8	J12	質量kg(1個) Weight	Jaw nut type
H01MA	4	25.5	15	16.5	10	5.5	14	11	5.5	M8	0.027
	5	30.5	15	16.5	10	5.5	19	11	5.5	M8	0.034
	6	37	17	21.5	12	8	20	14	7.5	M10	0.061
	8	46	20	23.5	14	10	25	15	8.5	M12	0.095
	10	51	23	23.5	16	10	30	15	8.5	M12	0.140
	12	53	28	33	18	11	30	19	14	M14	0.262
H037M	15	82	34	40	26	16	50	23	17	M20	0.560
	4	29	16	16.5	11	6.5	16	10	6.5	M8	0.036
	8	45	22	26.5	16	10	25	18	8.5	M12	0.120
	10	52	24	27.5	18	11	30	18	9.5	M14	0.161
	12	60	27	29	21	12	35	18.5	10.5	M16	0.242
H05M	15	74	34	40	26	16	42	23	17	M20	0.530
	12	65	27	29	21	12	40	18.5	10.5	M16	0.252
H3KT	6	36	17	18.5	12	8	20	11	7.5	M10	0.054
	8	46.5	20	20.5	14	10.5	25	12	8.5	M12	0.092
	10	51	22.5	21.5	16	11	30	13	8.5	M12	0.126
H063M	12	55.5	29.5	27.5	21	12	30	16	11.5	M16	0.211
	6	46.8	20.00	11.0	12.5	8.7	29.36	6.1	4.9	M10	0.050
H064M	8	53.3	22.25	13.3	14.1	9.6	34.13	7.5	5.8	M12	0.075
	10/12	68.4	28.30	17.6	18.9	12.0	44.45	10.3	7.3	M16	0.160

日系卡盤T型塊共用表 COMPATIBILITY OF T-NUT

Chuck series number											
H01MA	4	H022M5		H024M5							H012D4
	6	H022M6	H023M8	H024M6	H027M6	H034M6	H047M6	H037M6	H05M6	H032M8	H012D6
	15	H01MA18	H01MA21	H01MA24							
H037M	4				H027M4	H027M5		H037M5		H032M6	
	8	H022M8	H023M10	H024M8	H027M8	H034M8	H047M8		H05M8	H032M10	H012D8
	10	H022M10	H023M12	H024M10	H027M10	H034M10	H047M10		H05M10	H032M12	H012D10
	12				H027M12	H034M12	H047M12				
	15				H027M15	H034M15	H047M15				
H05M	12	H022M12	H023M15	H024M12							

日系卡盤軟爪系列2 (S1型)

SOFT JAWS FOR JIS SERIES S1 TYPE

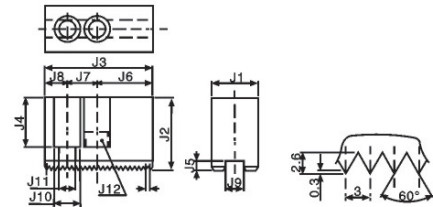

Chuck series number	Jaw number	Serration Pitch	J1※	J2※	J3※	J4※	J5	J6※	J7	J8※	J9	J10	J11	J12	質量kg(1個) Weight	
H01MA	6	401-062-0-000	3	40	55	87	40	6	51	20	16	12	17.5	11	M10	1.4
	8	401-062-1-000	3	40	60	102	42	6	57	25	20	14	20	13.5	M12	1.6
	10	401-062-2-000	3	50	70	123	52	6	63	30	30	16	20	13.5	M12	3
	12	401-062-3-000	3	62	80	144	63	6	75	30	39	18	23	15.5	M14	5