

## JHL橡膠筒夾固定型夾頭

## JHL RUBBER COLLET FIXED CHUCK

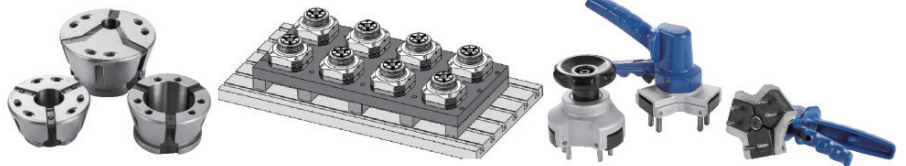

- ◎ 為固定式不可回轉。
- ◎ 注膠柔性筒夾，平行夾持，夾持面更大抓緊力更強。
- ◎ 長久壽命，高防水防塵能力。輕鬆控制兩端同心度、平行度。
- ◎ 多段尺寸可分次加工、降低設備成本。
- ◎ 以單動研磨機、取代CNC多段同時加工，需配后置氣油缸拉杆驅動。
- ◎ 適用CNC 銑鑽床 非標夾具等運用，可做聯排多工位夾具使用。
- ◎ 適用於精密工件的機加工。
- ◎ Fixed and non-rotating. Glue-injected flexible collet, parallel clamping, with a larger clamping surface and stronger gripping force.
- ◎ With a long service life, and good waterproof and dustproof capability. Allowing easy control over the concentricity and parallelism at both ends.
- ◎ Allowing separate size processing over multiple sections to reduce equipment costs.
- ◎ Replacing CNC multi-section simultaneous processing with single-action grinding machine.
- ◎ Requiring the provision of rear pneumatic/hydraulic cylinder rod drive.
- ◎ Suitable for non-standard fixtures for CNC milling and drilling machines; may be used as row-type multi-station fixtures.
- ◎ Suitable for machining of precision workpieces.

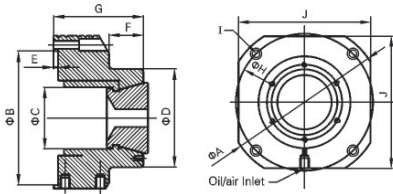

產品參數  
PARAMETERS

產品型號 Model	A	B	C	D	E	F	G	H	I	J	驅動方式 Drive Mode	使用壓力 Working Pressure Kg/cm <sup>2</sup>	夾持行程 Opening/Closing Stroke mm	使用夾爪 型號 Gripping Jaw Model
JHL-42	185	150	45	110	5	38.5	100.5	164	4-M8	158	空/油壓 Air/oil pressure	20	0.5	SK42
JHL-52	185	150	55	110	5	38.5	100.5	164	4-M8	158	空/油壓 Air/oil pressure	20	0.5	SK52
JHL-65	185	150	65	130	5	38.5	100.5	164	4-M8	158	空/油壓 Air/oil pressure	18	0.5	SK65

## JP系列 高速精密膜片夾頭

## JP SERIES HIGH SPEED DIAPHRAGM CHUCK

- ◎ 高精度三爪油壓膜片夾頭
- ◎ 夾頭本體密封，防塵防水防腐。低潤滑低保養需求
- ◎ 夾頭本體無滑動磨損，精度壽命長
- ◎ 適合高精度工件夾持加工
- ◎ 夾持力可以透過油缸出力精密微調
- ◎ 適合薄環件、薄管件、脆弱件夾持加工
- ◎ 搭配數控車床或精密研磨床工作



### 應用範例

- ◎ 軸承薄環件
- ◎ 數位相機零件
- ◎ 氣動手工工具組的零件加工
- ◎ 微小引擎的缸套與活塞加工
- ◎ 超薄環形零件，超薄鋁管零件
- ◎ 陶瓷零件加工

0.005mm repeatability.

Anti centrifugal force design. Clamping force remains high in high R.P.M.

Integrated dynamic-balancing-weights for fine balance adjustment.

No sliding parts to wear out.

Clamping force/stroke is proportional to actuating force.

Ideal for fragile parts, or thin-wall parts clamping.

\* 保留技術更改的權利，恕不另行通知 Subject to technology changes without prior information

\* 非標需求可訂做 Non-standard requirements can be made